

- For Lease -

**4849 Groveport Road
Columbus (Obetz), Ohio**

125,352 Sq. Ft.

7.9+ Acres

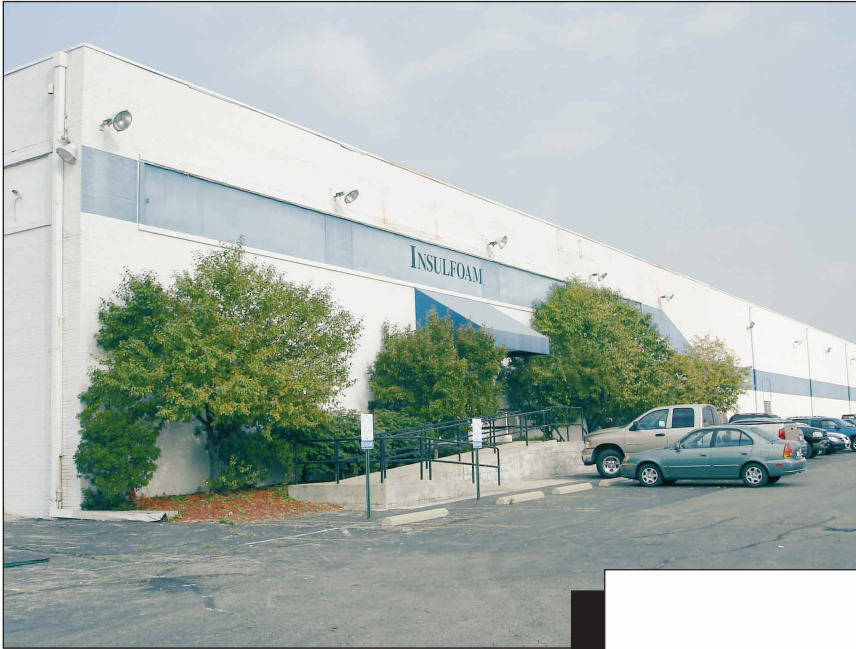

**Ohio Industrial Realty Co., Inc.
614-298-0800**

Contact:
**Rob Myers
John Myers**

SITE INFORMATION

4849 Groveport Rd.
Columbus (Obetz), Ohio
7.9 Acres
3.7 Additional Acres For Sale
Industrial Zoning
Heavy Electrical Service
American Electric Power Co.
Columbia Gas Energy Group
I-270 Proximity & Exposure

FACILITY INFORMATION

125,352 Sq. Ft. Total
11,972 Sq. Ft. Office
Constructed in 1968
348 Ft. x 360 Ft. Dimensions
14 Truck Docks & Levelers
2 Drive-in Doors
30 Ft. x 40 Ft. Bays
25 Ft. Clear Height
Gas Boilers

————— For Lease at \$2.40 per sq. ft. per year NET —————

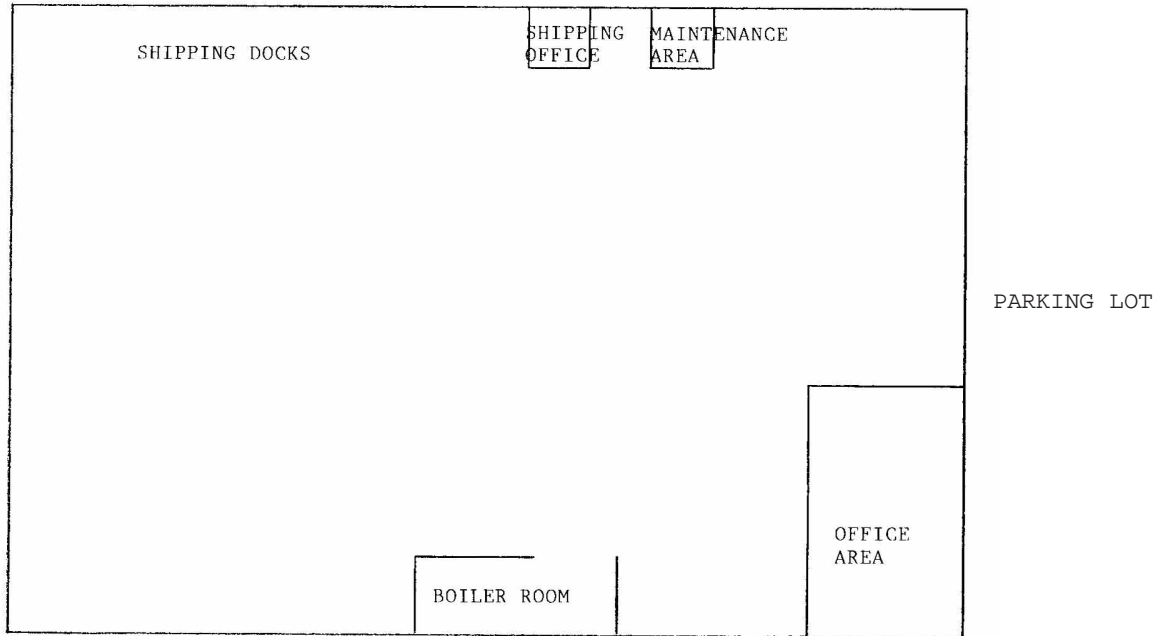

Ohio Industrial Realty Co., Inc.

778 Northwest Boulevard
Columbus, Ohio 43212